



FiberPatch

240×100mm

FIBER MANAGEMENT SYSTEM

Main Features

Allows you flexibility in creating your custom fiber optic cable management system.

Easy to install with your fiber routing system with no tools needed.

Applications

Create a fiber management system along the wall or ceiling of your data center or network closet or across the tops of the rack enclosures

240MM Main duct

Spec(mm)	Overall(mm)
w =240 H =100	240x 120 x 2000
Material	Color
PVC/ABS	Yellow



- Use to carry the cables horizontally throughout the system
- Accepts cover and fittings
- PN : FP240MD2

240MM HORIZONTAL 90° ELBOW

Name	Spec(mm)	Overall(mm)
240mm Horizontal 90° elbow	w =240 H =100	277*377*119
240mm Horizontal 90°elbow with cover	w =240	-
Material	Color	
PVC/ABS	Yellow	

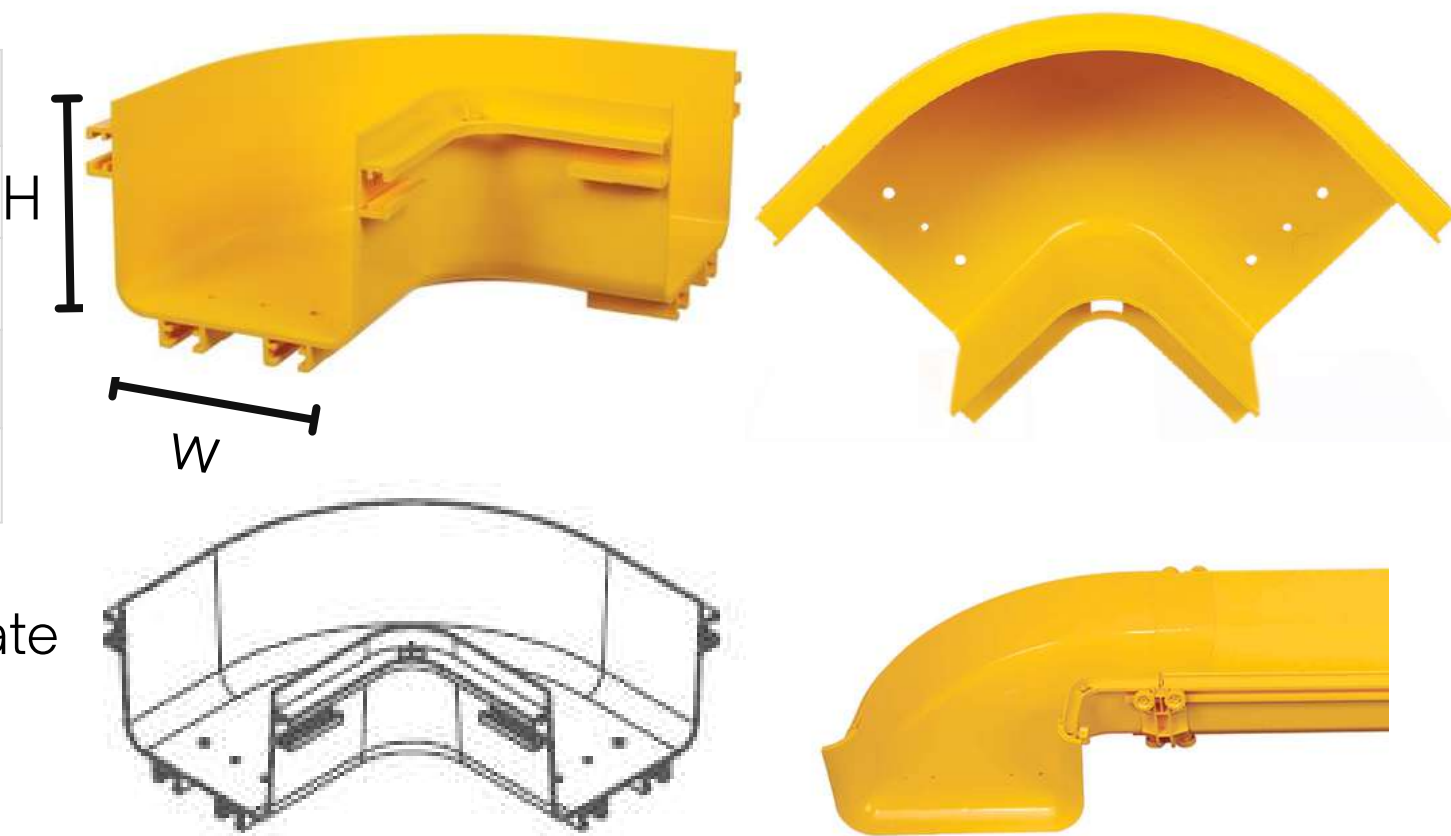

- Attaches to 240mmx100mm channel and/or fittings to create a 90° horizontal elbow from a straight horizontal run.
- PN : FP240HE90

240MM HORIZONTAL 45° ELBOW

Spec(mm)	Overall(mm)
w =240 H =100	319.5*287*121
Material	Color
PVC/ABS	Yellow

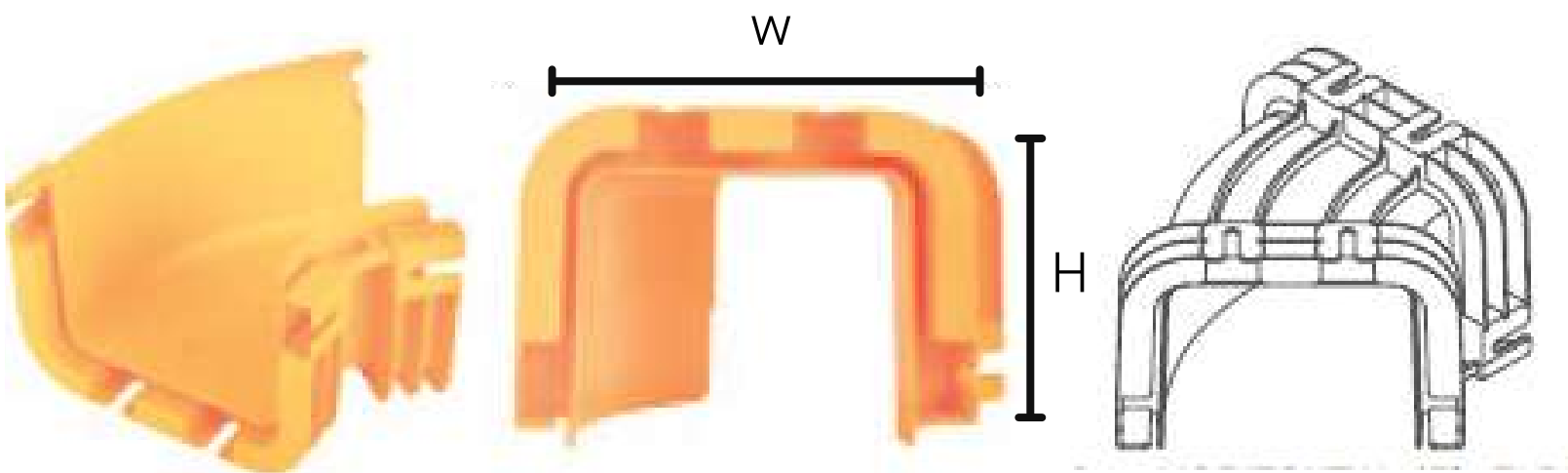

- Attaches to 240mmx100mm channel and/or fittings to create a 45° horizontal elbow from a straight horizontal run.
- PN : FP240HE90

240MM 45° UP ELBOW

Spec(mm)	Overall(mm)
w =240 H =100	275*210*167
Material	Color
PVC/ABS	Yellow

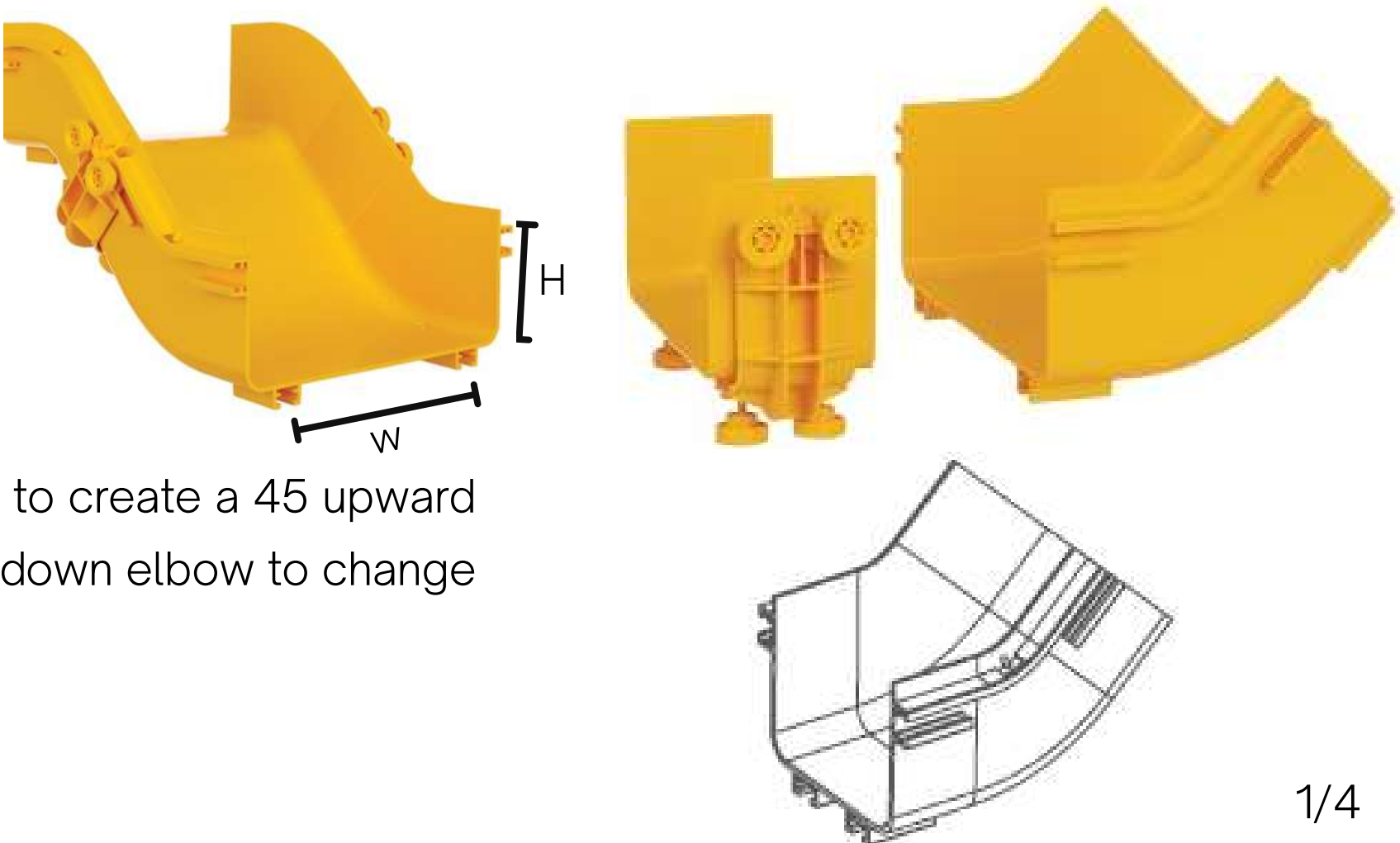

- Attaches to 240mmx100mm channel and/or fitting to create a 45 upward angle from a straight horizontal run. Used with 45° down elbow to change level of a horizontal run.
- PN : FP240UE45

240MM 45° DOWN ELBOW

Spec(mm)	Overall(mm)
w =240 H =100	277*187*161.5
Material	Color
PVC/ABS	Yellow



- Attaches to 240mmx100mm channel and/or fitting to create a 45° downward angle from a straight horizontal run. Used with 45° up elbow to change level of a horizontal run.
- PN : FP240DE45

240MM HORIZONTAL TEE

Name	Spec(mm)	Overall(mm)
240mm Horizontal TEE	w =240 H =100	276*376.5*119
240mm Horizontal TEE with cover	w =240	-
Material	Color	
PVC/ABS	Yellow	

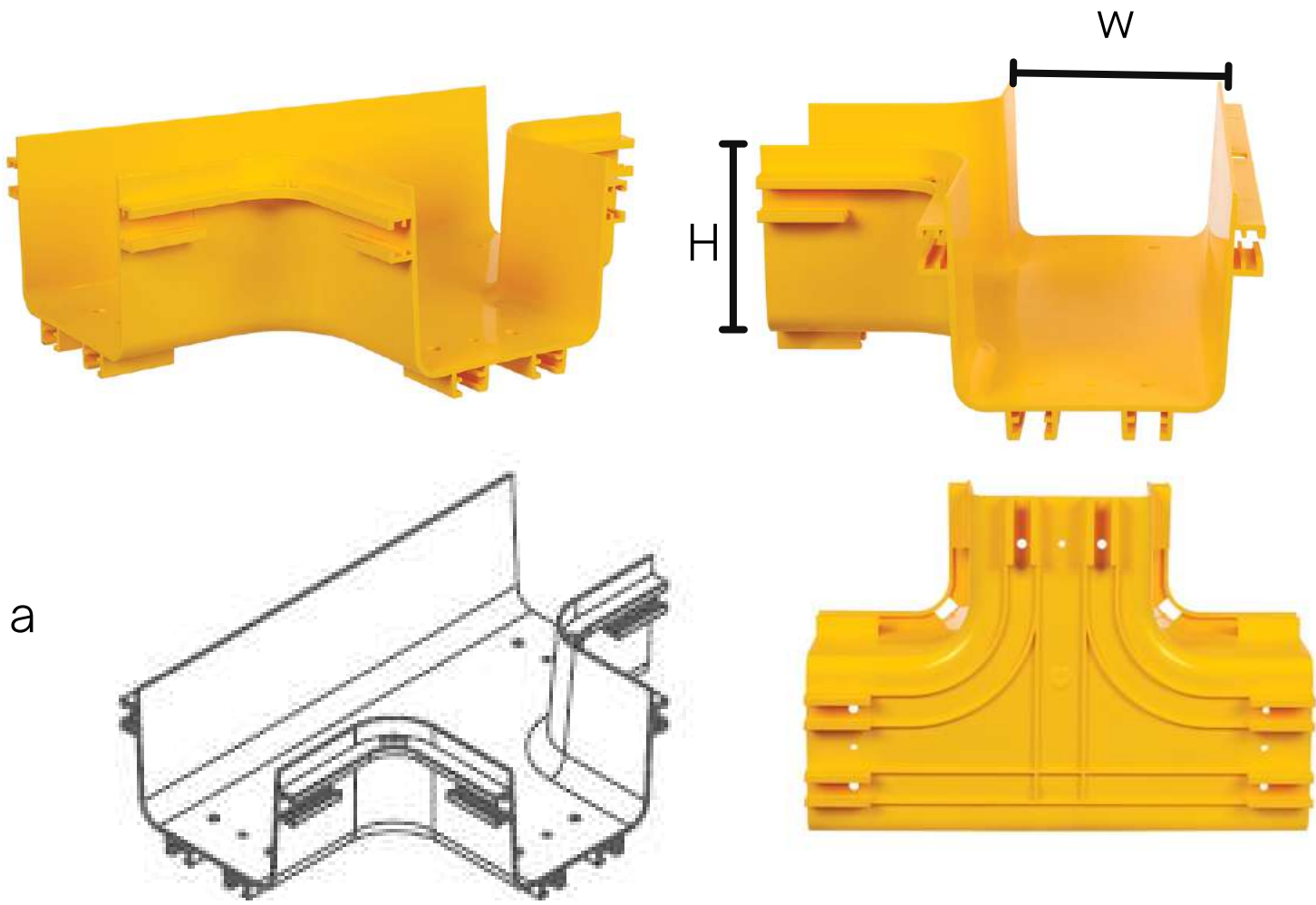

- Attaches to 240mmx100mm channel and/or fittings to creat a 90° horizontal branch from a straight horizontal run.
- PN : FP240HT

240MM CUTTING IN TEE

Spec(mm)	Overall(mm)
w =240 H =100	353*132*116
Material	Color
PVC/ABS	Yellow

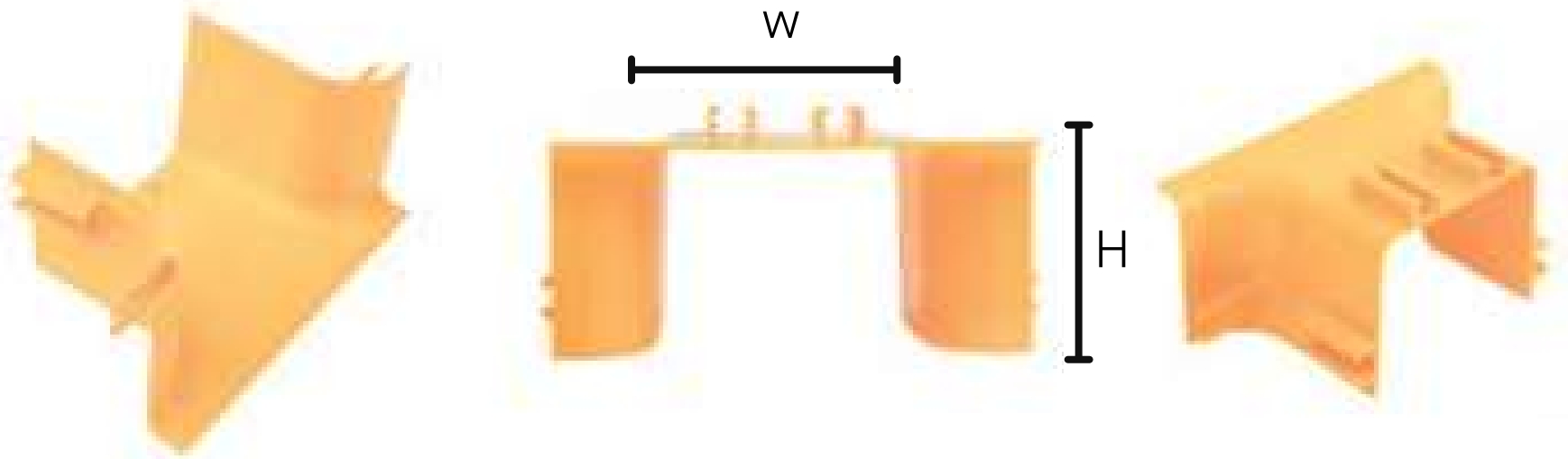

- Attaches to 240mmx100mm channel to create a 90 horizontal elbow from anywhere of a straight horizontal run.
- PN : FP240CT

240MM VERTICAL TEE

Spec(mm)	Overall(mm)
w =240 H =100	300*277*190
Material	Color
PVC/ABS	Yellow

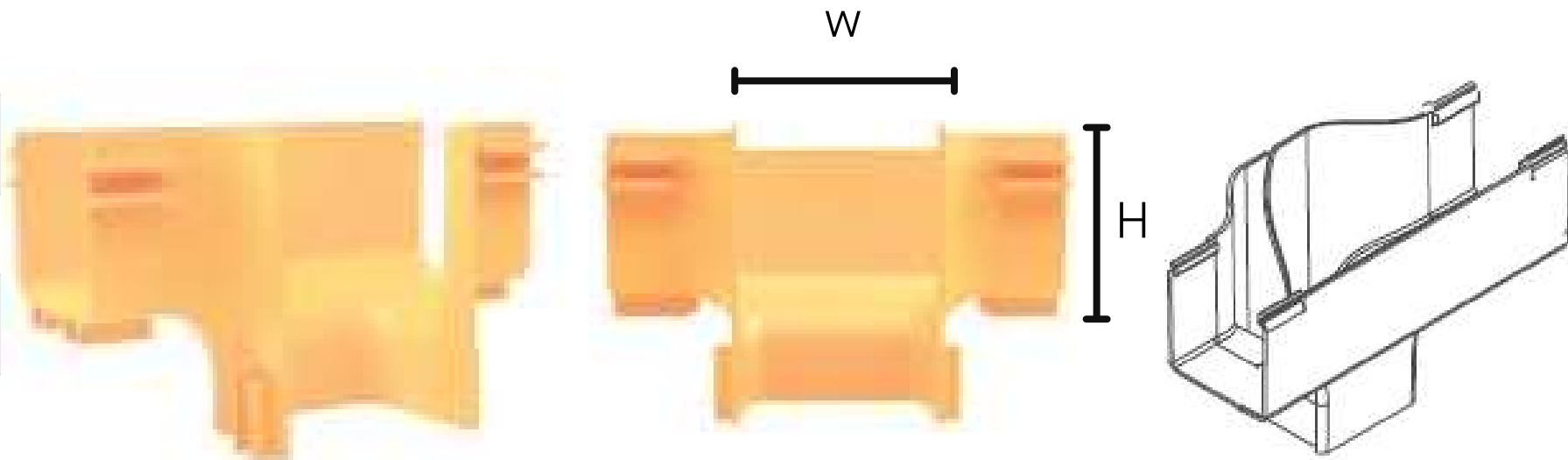

- Attaches to 240mmx100mm channel and/or fittings to create a 240mmx100mm 90° vertical drop from a horizontal run.
- PN : FP240VT

240MM HORIZONTAL CROSS

Name	Spec(mm)	Overall(mm)
240mm Horizontal cross	w =240 H =100	478*476*119
240mm Horizontal cross with cover	w =240	-
Material	Color	
PVC/ABS	Yellow	

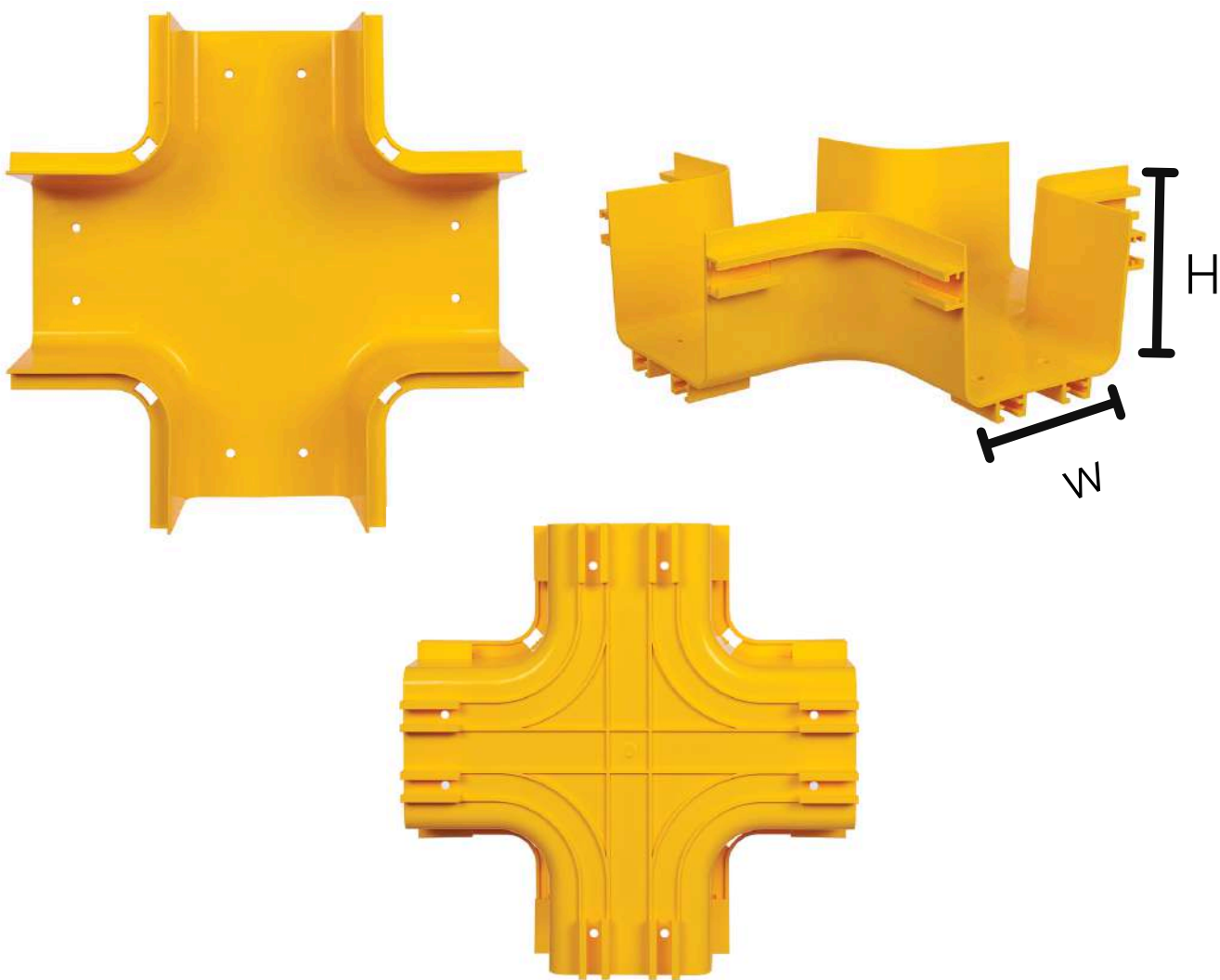

- Attaches to 240mm×100mm channel and/or fittings to create a horizontal four way cross intersection with two 240mm×100mm exits.
- PN :FP240CRS

240MM END CAP

Spec(mm)	Overall(mm)
w =240 H =100	270*25*115.5
Material	Color
PVC/ABS	Yellow

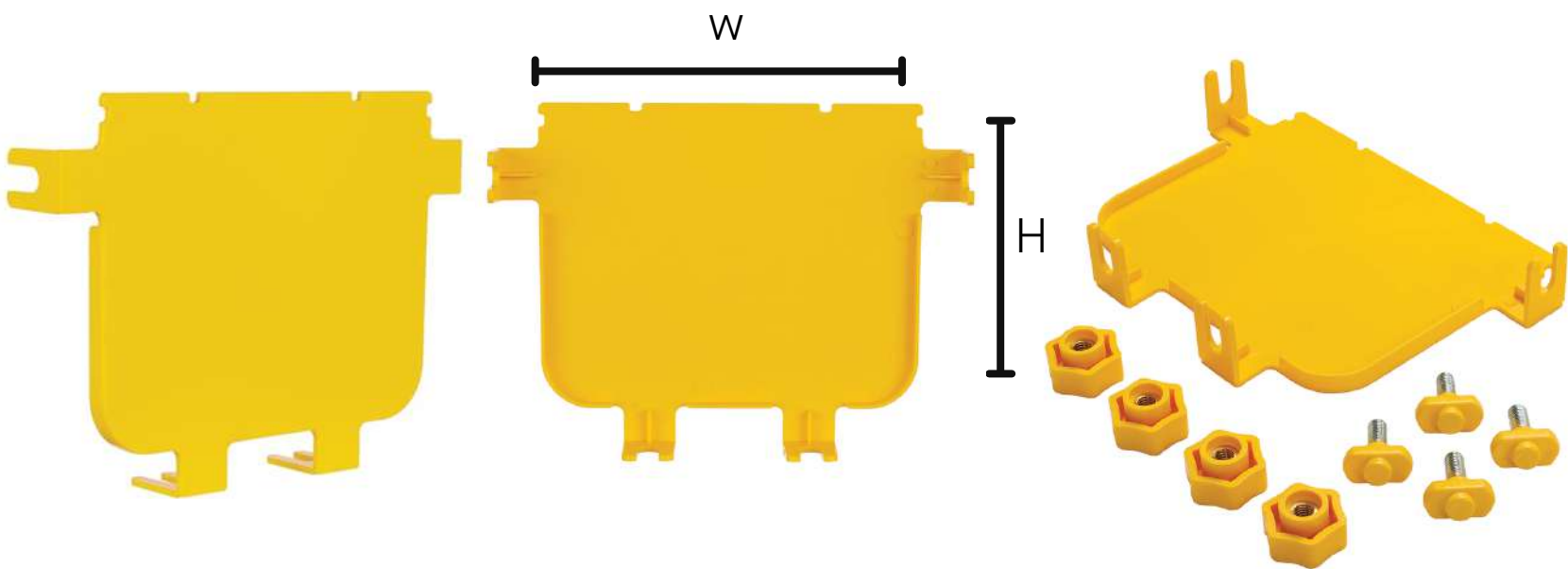

- Used for closing off open ends of the channel or fittings.
- PN : FP240EC

240MM JOINER

Spec(mm)	Overall(mm)
w =240 H =100	289*84*122
Material	Color
PVC/ABS	Yellow

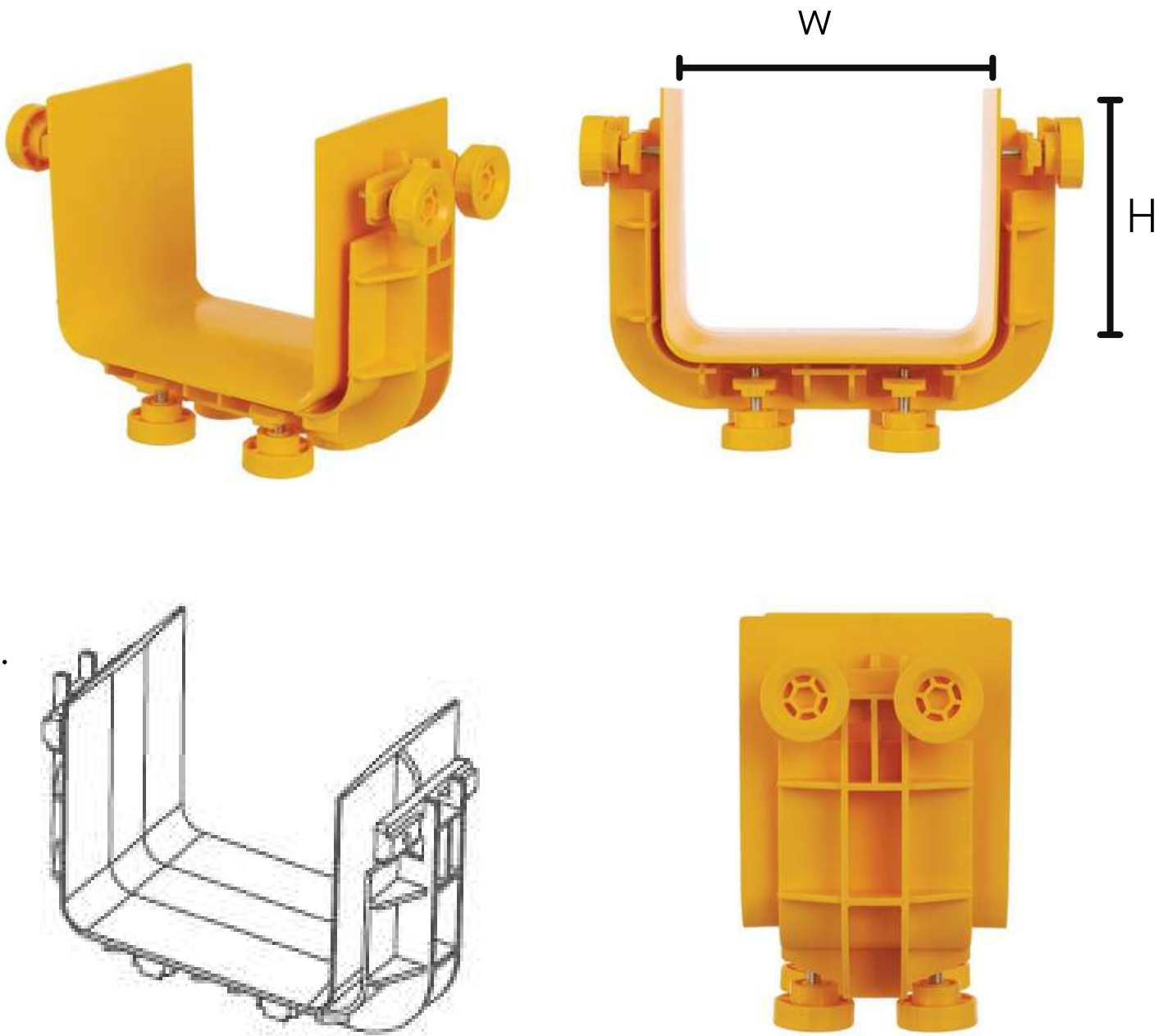

- Quickly joins two sections of channel and/or fittings.
- Tighten and release bolts by fingers, absolutely toolless.
- PN : FP240J

Quick Exit with cover

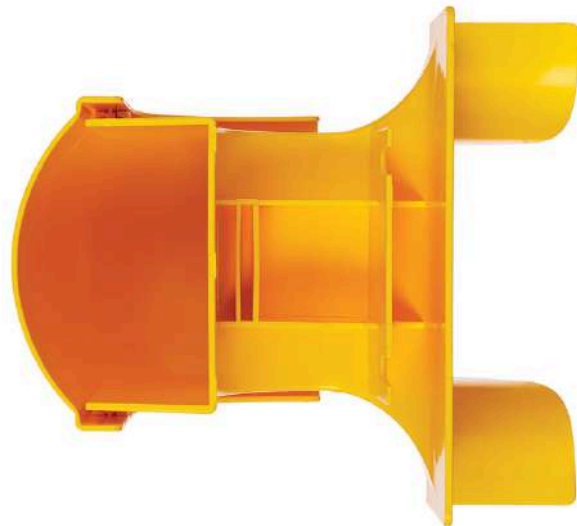
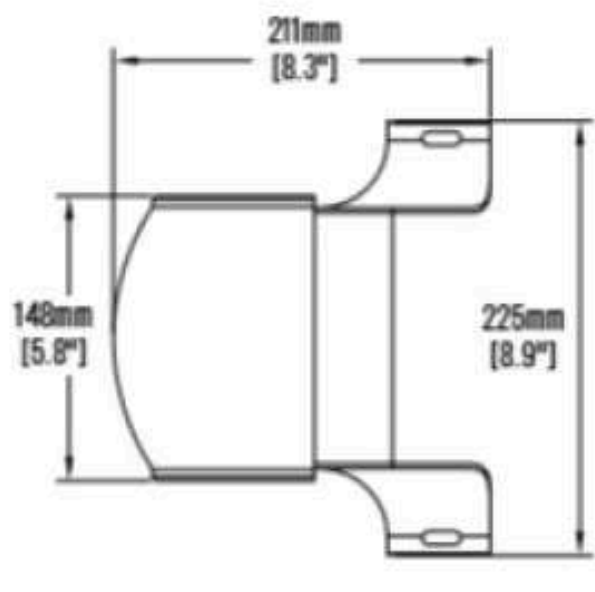
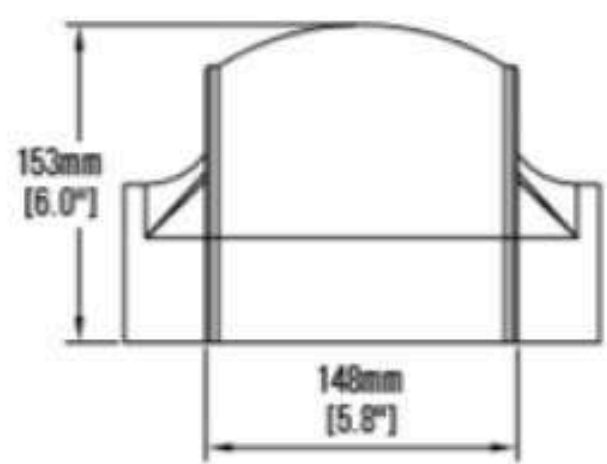
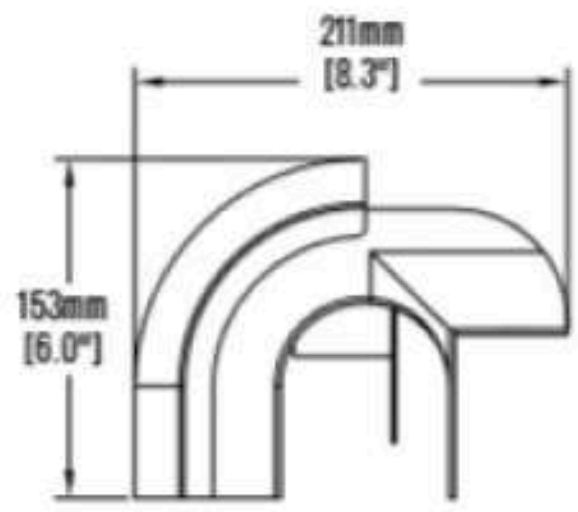

- Assembles onto all main duct sizes.
- PN : FPQE

Flex tube



- Movable exit maintains a proper bend radius for fiber optic cables that are routed over the side of your fiber management system.
- PN : FPFT42